

DWG.NO. HW1383257

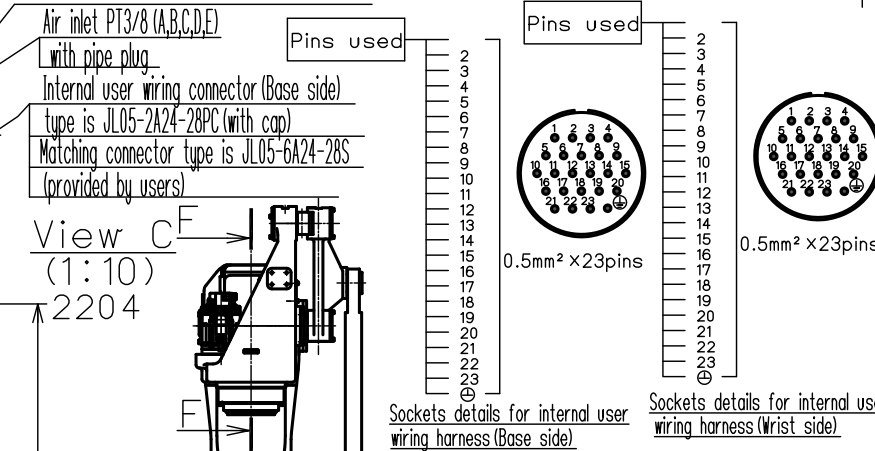
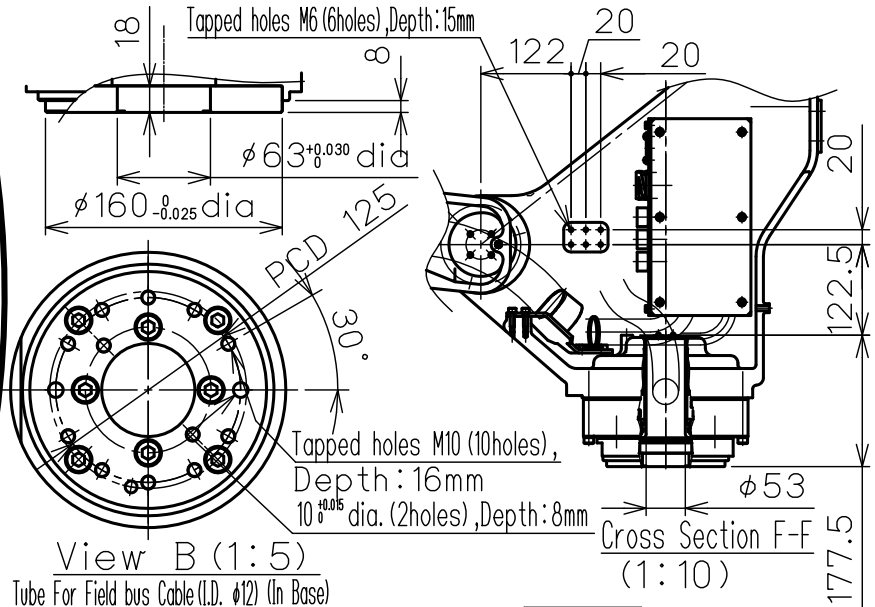
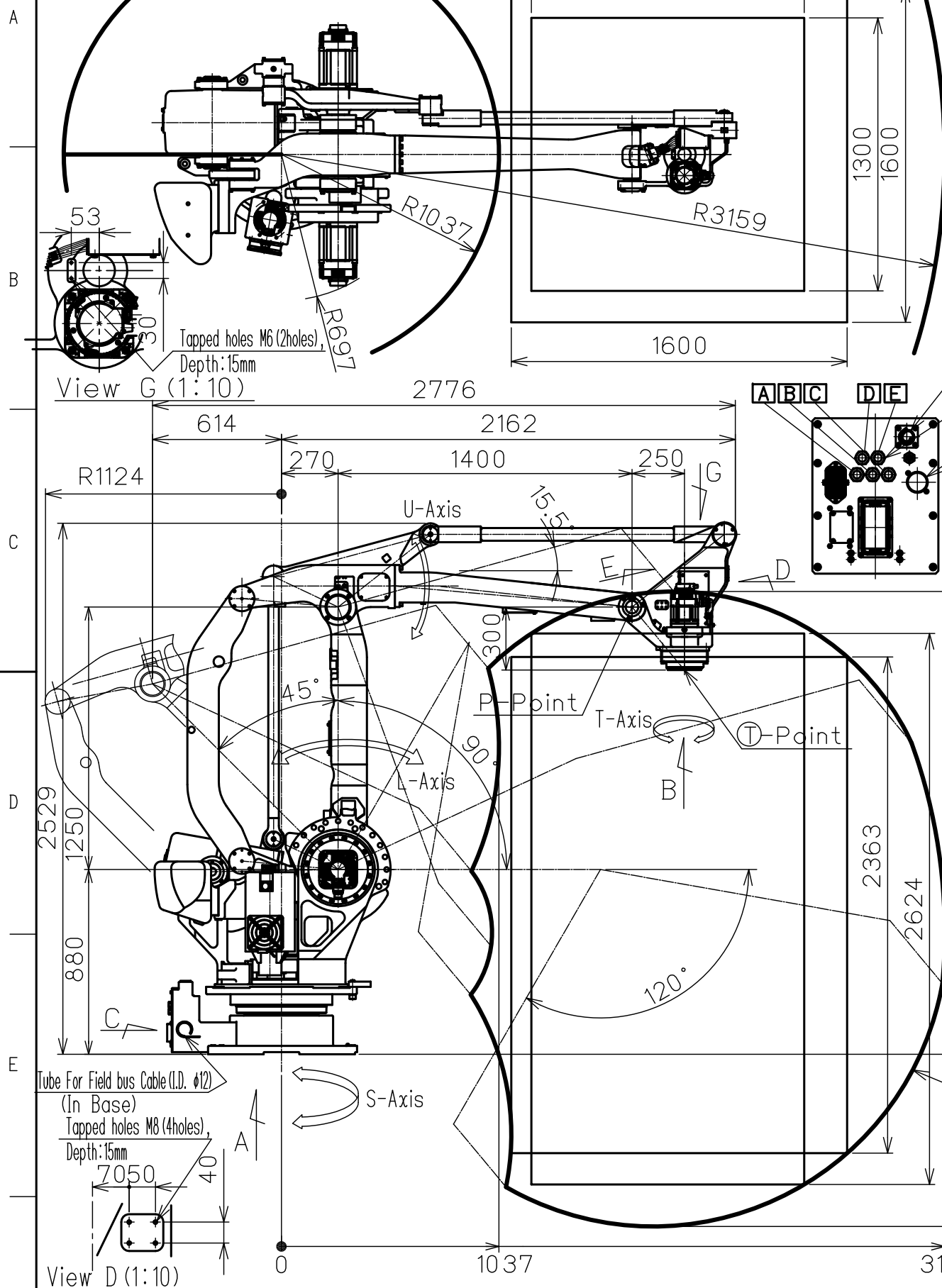

Model		MOTOMAN-MPL160II
Item	Configuration	Articulated Robot
	Degree of Freedom	4
	Payload	160kg
	Repeatability	±0.5 mm
Range of Motion	S-Axis(Turning)	±180°
	L-Axis(Lower Arm)	+90°, -45°
	U-Axis(Upper Arm)	+15.5°, -120°
	T-Axis(Twist)	±360°
Max Speed	S-Axis	2.44rad/s (140° /s)
	L-Axis	2.44rad/s (140° /s)
	U-Axis	2.44rad/s (140° /s)
	T-Axis	5.32rad/s (305° /s)
Allowable Inertia (GD ² /4)	T-Axis	80kg·m ²
Approx.Robot mass		1700kg
Ambient Conditions	Temperature	0~45° C
	Humidity	20~80%RH (Non-condensing)
	Vibration	Less than 4.9m/s ² (0.5G)
	Others	•Free from explosive or corrosive gas and liquid •Free from dust,oil, of water •Free from electrical noise
Power Requirements		9.5KVA

FOR STUDY PURPOSE ONLY

Type	Note
YR-MPL0160-J00	Standard

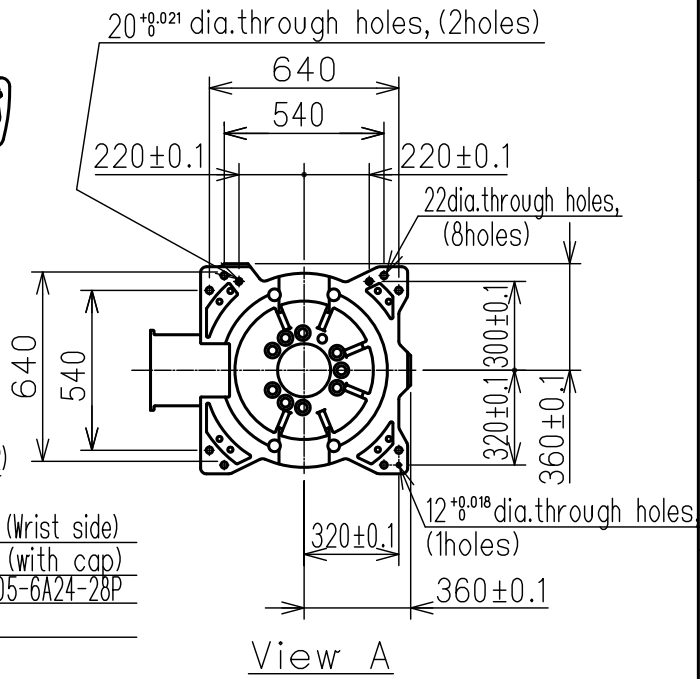

Note:
1.All rights reserved.
2.Please note that the data is subject to be deleted without advance notice.
3.No warranty is given in relation to the data including the specification.
4.We are not responsible for any damages or loss caused by the use of the data.

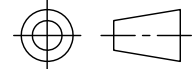

YASKAWA

株式会社 安川電機

Reference Drawing

TITLE MOTOMAN-MPL160II
DIMENSION DIAGRAM

DWG.NO.

HW1383257

SIZE A3