

MOTOMAN GP35H

Handling & General Applications
with the GP Series



The MOTOMAN GP35H is a high-speed hollow wrist robot featuring an extended reach for large parts. The electrical and additional cables run through the inside of the wrist, which improves the mobility of the robot and at the same time minimises the risk of damage; there are no interfering contours due to external cable packages.

This 35 kg payload robot is suitable for a precise medium payload applications like pick & place, machine loading, material handling, assembly, dosing and deburring as well as grinding. As no interference factors need to be taken into account, this robot offers superior performance in vision applications, offline and on-site teaching operations and is advantageous in offline programming.

The internal cable routing allows maximum acceleration and thus fast and reliable movements. As a result of its high moment of inertia, the GP35H handles large grippers and parts within large working ranges with its reach of 2070 mm.

KEY BENEFITS

- Internal cable routing eliminates interference contours, cable snagging and enables maximum acceleration
- High speed and high precision
- Dust and liquid-tight wrist (protection class IP67)
- Large horizontal reach

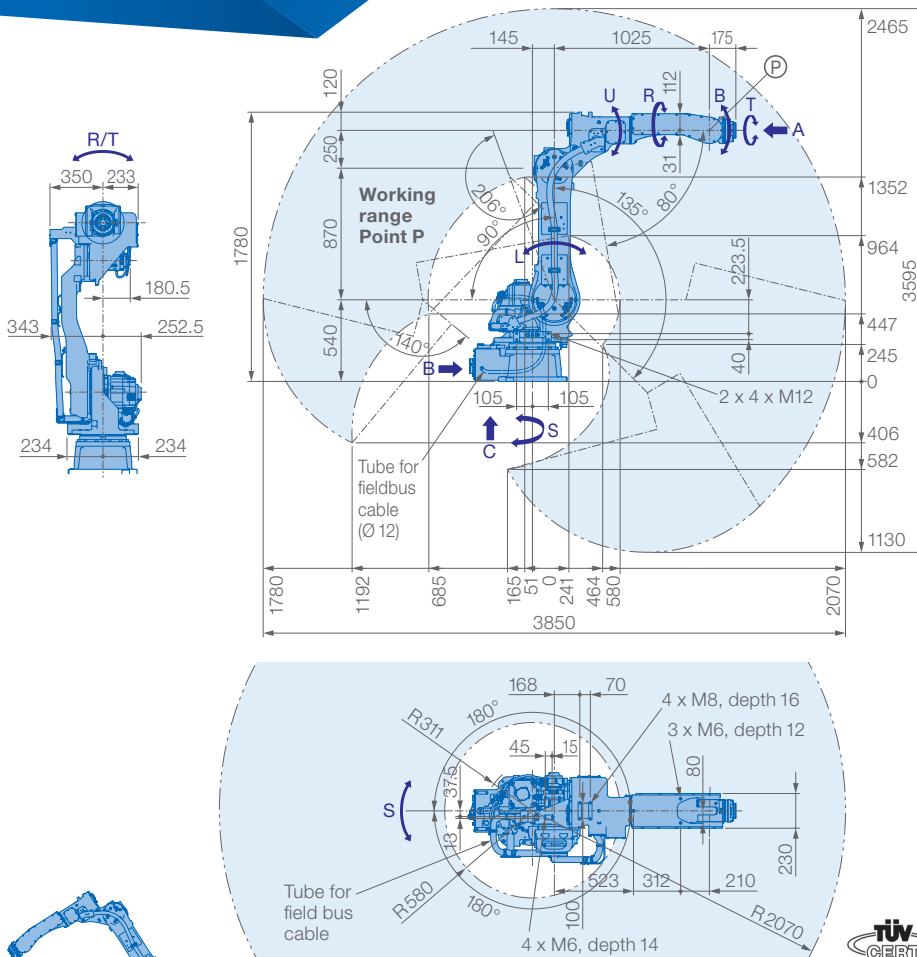

View A

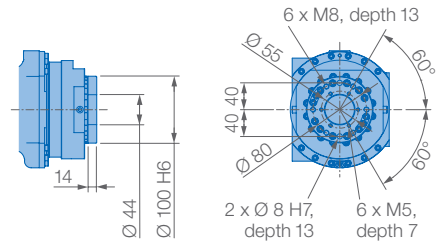

View B

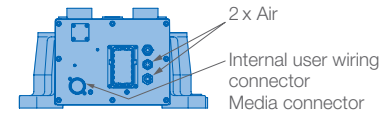

View C

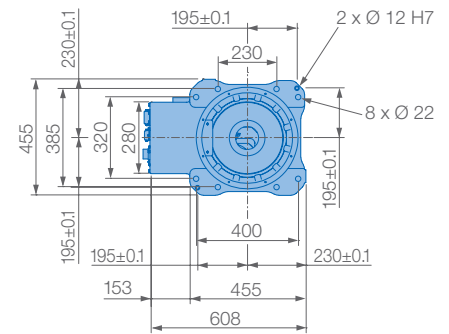

Allowable wrist load

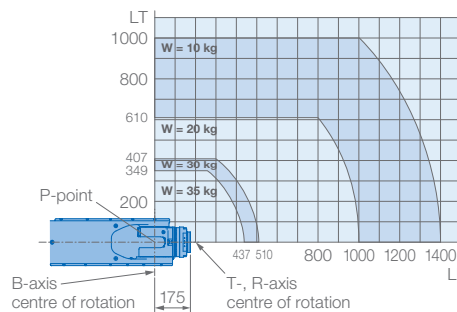

Mounting options: Floor, ceiling, wall, tilt*

Protection class version YR-1-06VXH35-A00
Standard: Main axes (S, L, U) IP54, wrist IP67

* tilt with condition of angle – see table below

Wrist + U-arm in front	Up to 35 kg for attaching load mass including wrist load
U-arm behind	Up to 10 kg. 49 N · m max. for increased moment amount of upper arm (floor-, ceiling-mounted type only)
S-axis below	Up to 30 kg (floor-, ceiling-mounted type only)

Robot installation angle θ [deg.]	S-axis operating range [deg.]
$0 \leq \theta \leq 30$	± 180 (Standard)
$30 < \theta \leq 35$	± 60
$35 < \theta \leq 45$	± 45
$45 < \theta$	± 30

Specifications GP35H					
Axes	Maximum motion range [°]	Maximum speed [°/sec.]	Allowable moment [Nm]	Allowable moment of inertia [kg · m ²]	Controlled axes
S	± 180	180	–	–	6
L	$+135/-90$	180	–	–	Max. payload [kg]
U	$+206/-80$	200	–	–	Repeatability [mm]
R	± 200	350	150	20	Max. working range R [mm]
B	± 125	350	150	20	Temperature [°C]
T	± 360	400	120	10	Humidity [%]
					Weight [kg]
					Power supply, average [KVA]

Robotics Division

YASKAWA Europe GmbH
Yaskawastraße 1
85391 Allershausen, Germany
Tel. +49 (0) 8166/90-0
Fax +49 (0) 8166/90-103
robotics@yaskawa.eu
www.yaskawa.eu

YASKAWA Headquarters Academy and Sales Office

YASKAWA Europe GmbH
Philipp-Reis-Straße 6
65795 Hattersheim am Main, Germany
Tel. +49 (0) 6196/77725-0
Fax +49 (0) 6196/77725-39

All drawing dimensions in mm. Technical data may be subject to change without previous notice. Please request detailed drawings at robotics@yaskawa.eu.

YR-1-06VXH35-A00
A-11-2024, A-No. 231062

YASKAWA