

DWG.NO. HW1386598

A

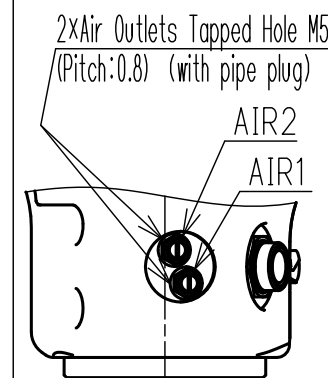

**View D**  
(Scale=1/3)

Connector for I/O cable (S-2):  
RM15WTRZA-8S (with cap)  
Connector prepared by user:  
RM15WTPZA-8P or the equivalent

40<sup>+0.025</sup> dia. Hole  
(Depth:6)

Tapped Holes M6 (4 Holes)  
(Depth:10, Pitch:1.0)  
(Tightening torque for  
attachment:13.7N·m)

6<sup>+0.012</sup> dia. Holes (2 Holes)  
(Depth:6)

**View C (Scale=1/3)**

Detail of I/O Cable Connector

Connector-Base side

End-Flange side

1	0.2mm <sup>2</sup>	1	
2	0.2mm <sup>2</sup>	2	
3	0.2mm <sup>2</sup>	3	
4	0.2mm <sup>2</sup>	4	
5	0.2mm <sup>2</sup>	5	
6	0.2mm <sup>2</sup>	6	
7	0.2mm <sup>2</sup>	7	
8	0.2mm <sup>2</sup>	8	
9	0.3mm <sup>2</sup>	1	
10	0.3mm <sup>2</sup>	2	
11	0.3mm <sup>2</sup>	3	
12	0.3mm <sup>2</sup>	4	
13	0.3mm <sup>2</sup>	5	
14	0.3mm <sup>2</sup>	6	
15	0.3mm <sup>2</sup>	7	
16	0.3mm <sup>2</sup>	8	

Connector for I/O cable (S):  
RM21WTR-20P (with cap)  
Connector prepared by user:  
RM21WTP-20S or the equivalent

Main Key (upper-side)

2XAir Inlets Tapped Hole M5  
(Pitch:0.8) (with pipe plug)

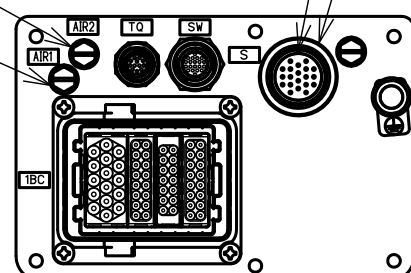

**View B (Scale=1/3)**

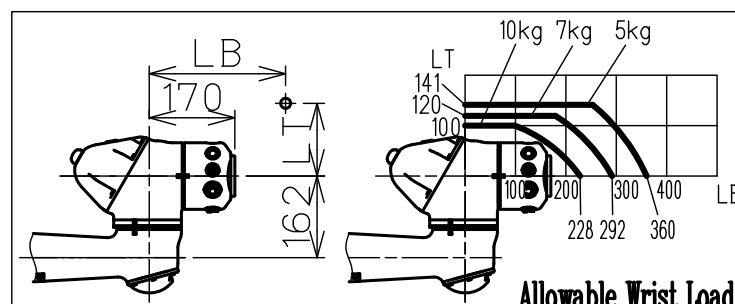

**Allowable Wrist Load**

Connector for I/O cable (S-1):  
LF10WBRB-12S (with cap)  
Connector prepared by user:  
LF10WBP-12P or the equivalent

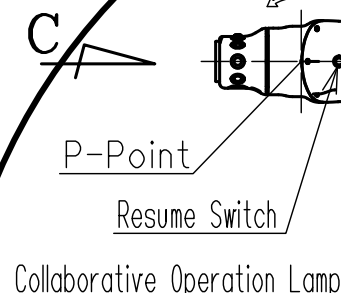
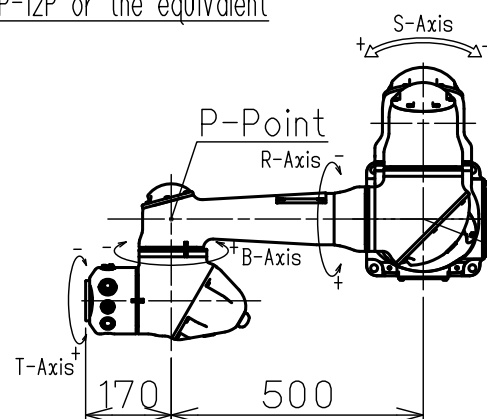

Type	Specification
YR-1-06VXHC10-F10	<ul style="list-style-type: none"> <li>With Direct Teach Button</li> <li>Special surface treatment and food grade specifications</li> <li>Built-in Air Hoses and I/O (16wires) Cables</li> </ul>

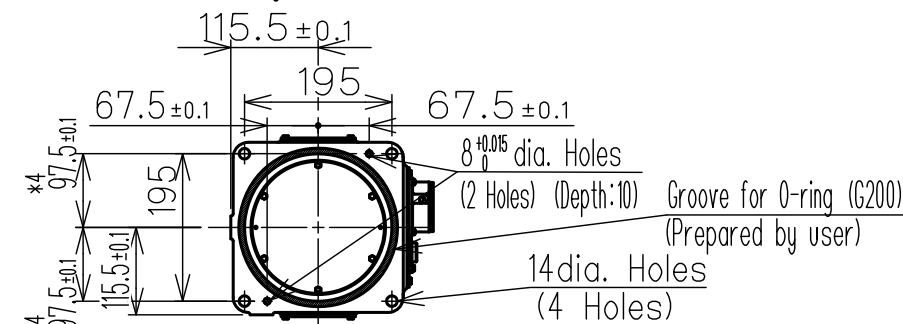

**View A (Scale=1/10)**

Units:mm

Item	Model	MOTOMAN-HC10DTF
Configuration		Vertically Articulated
Degree of Freedom		6
Payload		10kg
Repeatability *1		0.05mm
Range of Motion	S-Axis (Turning) *3	-180° - +180°
	L-Axis (Lower Arm)	-180° - +180°
	U-Axis (Upper Arm)	-95° - +265°
	R-Axis (Roll)	-180° - +180°
	B-Axis (Pitch/Yaw)	-180° - +180°
	T-Axis (Twist)	-180° - +180°
Maximum Speed	S-Axis	2.27rad/s, 130°/s
	L-Axis	2.27rad/s, 130°/s
	U-Axis	3.14rad/s, 180°/s
	R-Axis	3.14rad/s, 180°/s
	B-Axis	4.36rad/s, 250°/s
	T-Axis	4.36rad/s, 250°/s
Allowable Moment	R-Axis	27.4N·m (2.8kgf·m)
	B-Axis	27.4N·m (2.8kgf·m)
	T-Axis	9.8N·m (1.0kgf·m)
Allowable Inertia (GD <sup>2</sup> /4)	R-Axis	0.78 kg·m <sup>2</sup>
	B-Axis	0.78 kg·m <sup>2</sup>
	T-Axis	0.1 kg·m <sup>2</sup>
Approx. Mass		58kg
Protected Structure		IP67
Cleanliness (Reference) *5		Equivalent to ISO class 5
Mounting Method		Floor-, Tilt-, Wall-, Ceiling-mounted
Ambient Conditions	Temperature	0 °C to 40 °C
	Humidity	20%RH to 80%RH (Non-Condensing)
	Vibration	4.9m/s <sup>2</sup> (0.5G) or less
	Altitude	1000m or less
	Others	<ul style="list-style-type: none"> <li>Free from explosive and corrosive gas or liquid.</li> <li>Free from excessive electrical noise (plasma).</li> <li>Free from strong magnetic field.</li> </ul>
Power Requirements		1.0kVA
Controller		YRC1000/YRC1000micro

\*1 Repeatability conforms to ISO 9283.  
\*2 The manipulator is in the home position on this drawing.  
\*3 Range of motion for S-axis will be limited when the manipulator is tilt- or wall-mounted.  
\*4 The tolerance applies to 8<sup>+0.015</sup> dia. holes.  
\*5 The cleanliness is for reference and not guaranteed.

F

Note:  
1.All rights reserved.  
2.Please note that the data is subject to be deleted without advance notice.  
3.No warranty is given in relation to the data including the specification.  
4.We are not responsible for any damages or loss caused by the use of the data.

FOR STUDY PURPOSE ONLY

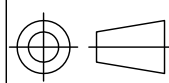

SCALE 1:15

**YASKAWA**  
株式会社 安川電機

Reference Drawing

TITLE MOTOMAN-HC10DTF  
DIMENSION DIAGRAM

DRWN DATE Oct. 07, 2019

DWG.NO. HW1386598

SIZE A 3